

## CMHD Series For HDMI, Applications

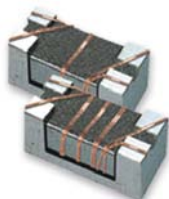

Based on Chilisin's technical expertise, we have introduced a full series of common mode choke. They are designed for excellent noise attenuation with a compact size for wide applications such as USB line for personal computers and peripheral, DVC, STB and LVDS, panel line for liquid display panels, etc. We welcome you to contact us for requirement of our standard series or custom design service.

### Features

- RoHS Compliant
- Miniature SMD type common mode filter for fully automated assembly.
- Excellent Solderability.

### Applications

- HDMI
- DVI
- Display port

### Product Identification

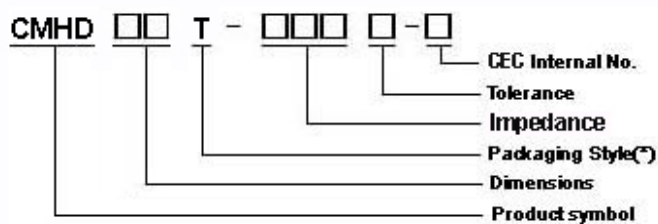

- Packaging: T : Tape and Reel

### Shapes and Dimensions

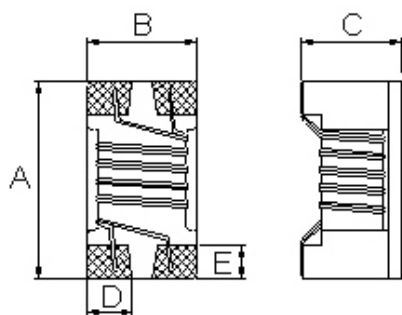

Dimensions in mm

TYPE	A	B	C	D	E
CMHD21	2.05±0.2	1.25±0.2	1.20±0.2	0.50	0.58

### Recommended Pattern

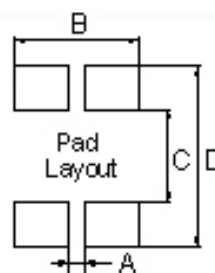

Dimensions in mm

TYPE	A	B	C	D
CMHD21	0.50	1.20	0.80	2.60

## Electrical Characteristics

Part Number	Impedance (Ω)	Test Frequency (MHz)	Tolerance (±%)	Idc (mA) Max	Rated Voltage (Vdc)	Rdc (Ω) Max	Insulation Resistance (MΩ) Min
CMHD21T-670M-N	67	100	20	400	50	0.30	10
CMHD21T-900M-N	90	100	20	300	50	0.40	10
CMHD21T-121M-N	120	100	20	250	50	0.45	10

- When ordering, please specify tolerance and packaging codes.
- Tolerance : M = ±20%
- Packaging : Clear tape and reel { standard }.
- Z : HP4286A / HP4287A / Agilent/HP4291A
- Rdc(single line) : CH502BC
- Idc : HP4284A+HP42841A/HP4285A+HP42841A
- Insulation Resistance : Agilent /HP4339B
- Operating temperature range from -40℃ to 105℃. (Including self - temperature rise )

**Test Instruments :** HP4291A Material/Impedance Analyzer

**Typical Impedance vs. Frequency**

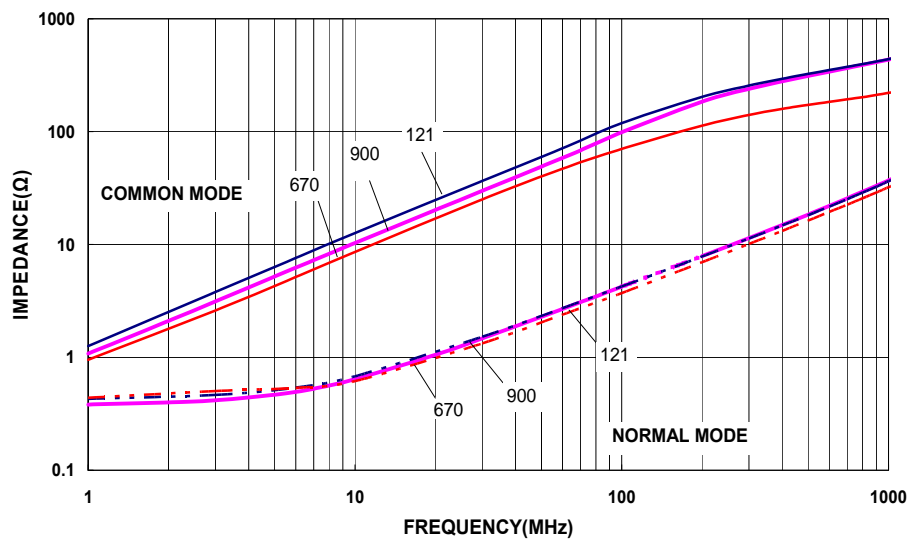

## Packaging Specifications

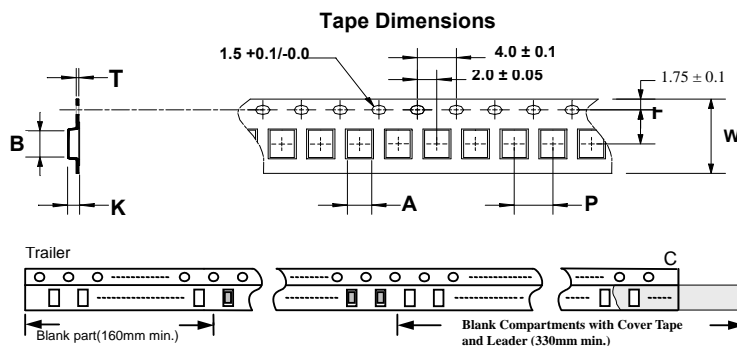

Dimensions in mm

TYPE	Tape Dimensions							Reel Dimensions				Quantity PCS / Reel
	A	B	T	W	P	F	K	A	B	C	D	
CMHD21	1.50	2.25	0.24	8	4	3.5	1.45	178	60	12	1.5	2000